



CONNEXOON  
ACCESS

# Thank you



for choosing **C[]NNEXOON**  
**ACCESS**

Do you need any information? Do you need any help?  
[www.somfy.com](http://www.somfy.com)

# CNNEXOON

## 1 UNIT, 3 ENVIRONMENTS, 3 APPLICATIONS



## SWITCH TO CONNECTED MODE

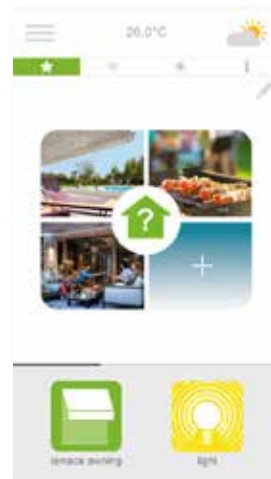

### 3 apps to switch the device in your home to connected mode

A choice of 3 apps for control from a smartphone

3 home environments: window shutters and blinds - the terrace - entrances.

The benefits of being connected to your house and your devices, whether you are personally present or away from home.

Unique, intuitive, convenient functions that everyone can use and that bring the peace-of-mind and well-being that make home living even more enjoyable.

# CONNEXOON

## WELCOME HOME!

### Top functions:

#### Welcome

Open the gate and garage door, deactivate the alarm and turn on the lights just before you arrive home. Close everything again automatically once the car is parked... thank you geolocation, welcome home!

#### Check access

Control the alarm even when you are away, monitor the state of the entrances... enjoy peace-of-mind and keep your home safe, even when you are far away.

ENJOY THE BENEFITS OF BEING CONNECTED

Connexoon Access is compatible with:



Gate io



Garage door io



Connected lock io



io alarm



Lights io



Plugs io



Philips Hue Lighting

## [1] Connexoon

- The Pack
- The Connexoon unit

## [2] Installing Connexoon

- Quickly store the io-homecontrol products in the Connexoon unit (prog-prog)
- Activate the Connexoon unit.
- Download the Connexoon application

## [3] Using Connexoon Access

- The interface
- Controlling my products
- The modes
- Check Access

## [4] Managing my installation

- Dashboard
- Messages
- Settings
- My account
- Help

## [5] Advanced installation functions

- Connecting io-homecontrol devices
- Managing the io-homecontrol system key (only for installers)
- Sending the io-homecontrol security key
- Generating the io-homecontrol security key
- Receiving the io-homecontrol security key
- Available tutorials





# [1] CONNEXOON



## A. THE PACK



### The pack contains

- 1 The Connexoon unit
- 2 USB charger
- 3 Mains adapter
- 4 Ethernet cable
- 5 2 Quick-start installation guides (installer and end user)
- 6 Legal notice

## B. THE CONNEXOON UNIT



PROG

LAN

USB

LED

Button used for the fast pairing of your Connexoon unit and your Somfy power-operated devices, without an internet connection [see page 12 pairing](#) prog-prog products. (connection enabling the Connexoon unit to communicate with your devices).

Connect the USB charger to the USB port on your Connexoon unit in order supply power to your product.

Connect the Ethernet cable between your Connexoon unit and your broadband modem.



## [2] INSTALLING CONNEXOON

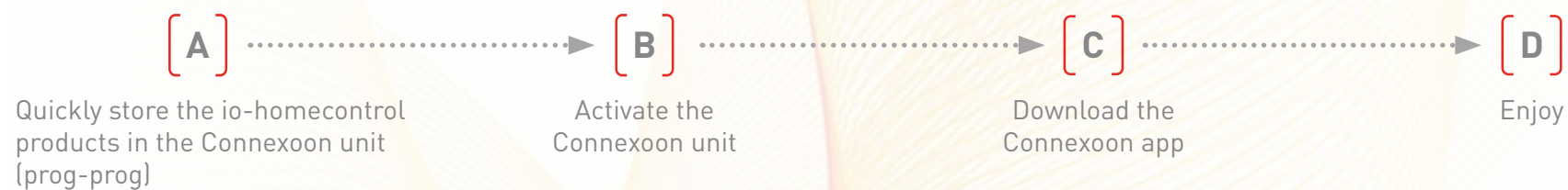

## A. QUICKLY STORE THE IO-HOMECONTROL PRODUCTS in the Connexoon unit (prog-prog)

If the devices you want to connect are paired with a remote control without feedback function (Smoove, Keygo):

The simplified procedure below makes it possible to perform pairing without an internet connection and without activating the account.

- [1] Connect the Connexoon unit to the power supply.
- [2] Press the PROG button on your control point for 3 seconds.
- [3] Then briefly press the PROG button on the Connexoon unit for 0.5 seconds.
- [4] After storing all your devices, press for 8 seconds on the Connexoon unit. Your devices will then move up and down a short distance. This confirms that your products are paired.

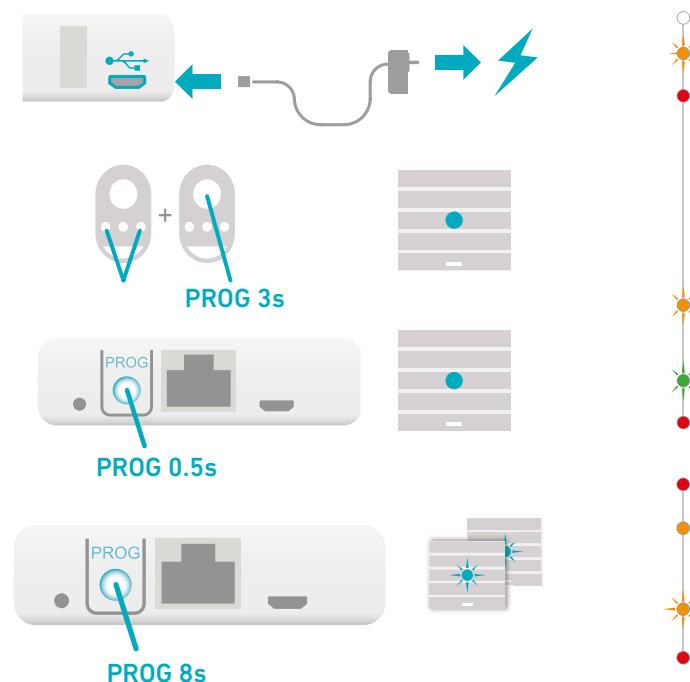

If the installation contains a control with feedback function, see [page 41](#).

## B. ACTIVATE THE CONNEXOON UNIT

Log in to  
**somfy-connect.com**

Step 1

Select your country and language in the section "Activate a box".

Step 2



Press on Connexoon.

Step 3



Enter the PIN for your Connexoon unit.

Step 4



Select Connexoon Access.

## B. ACTIVATE THE CONNEXOON UNIT

Steps needed to activate Connexoone Access

Step 5

CONNEXOON ACCESS

STEP 1: Email et mot de passe

STEP 2: Vos informations

STEP 3: Récapitulatif

1 Email et mot de passe

Vous devez créer votre adresse email, et définir votre mot de passe pour créer votre compte.

Adresse email

Confirmation email

Mot de passe

Confirmer le mot de passe

JE CONTINUE

Define your login and password.

Step 6

CONNEXOON ACCESS

STEP 1: Email et mot de passe

STEP 2: Vos informations

STEP 3: Récapitulatif

2 Vos informations

Vous devez renseigner vos informations personnelles pour créer votre compte.

Nom

Prénom

Adresse

Zip code

City

Mon numéro de téléphone

Vous pouvez recevoir les offres Connexoone par email et par courrier postal.

Je souhaite recevoir les offres Connexoone par email et par courrier postal.

Je souhaite recevoir les offres Connexoone par email et par courrier postal.

JE CONTINUE

Enter your personal details.

Step 7

CONNEXOON ACCESS

STEP 1: Email et mot de passe

STEP 2: Vos informations

STEP 3: Récapitulatif

3 Récapitulatif

Vous allez recevoir un email récapitulatif de votre compte Connexoone, avec un lien vers votre compte.

Vous pouvez recevoir les offres Connexoone par email et par courrier postal.

Je souhaite recevoir les offres Connexoone par email et par courrier postal.

Je souhaite recevoir les offres Connexoone par email et par courrier postal.

VALIDER ET PAYER

Check the information you have entered.

Step 8

CONNEXOON ACCESS

Votre box domotique est bientôt activée !

Vous allez recevoir un email récapitulatif de votre compte Connexoone, avec un lien vers votre compte.

Vous pouvez recevoir les offres Connexoone par email et par courrier postal.

Je souhaite recevoir les offres Connexoone par email et par courrier postal.

Je souhaite recevoir les offres Connexoone par email et par courrier postal.

RETOUR SUR SOMFY CONNECT

Confirm.

## B. ACTIVATE THE CONNEXOON UNIT

Receipt of a confirmation email



You receive a confirmation email.

Press the link "Continue" to complete activation of the Connexoon unit.



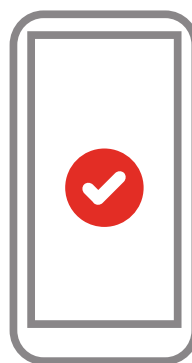

## C. DOWNLOAD THE CONNEXOON ACCESS APPLICATION to your smartphone

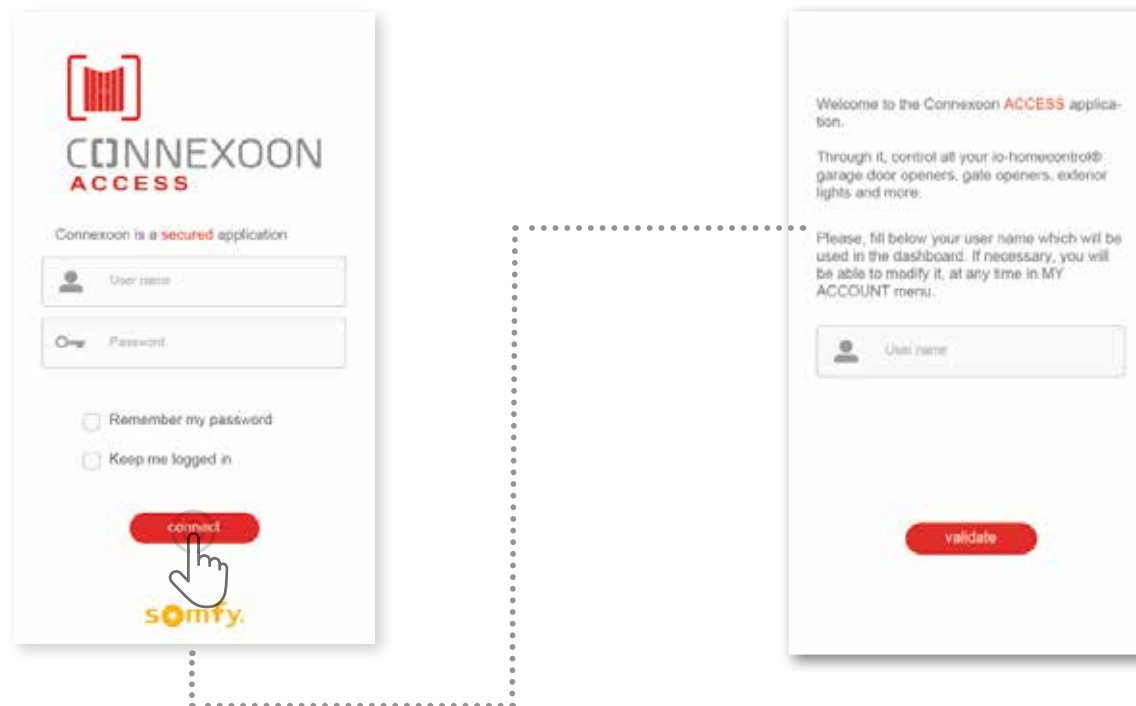

Download the Connexoon Access smartphone application  
that is available for IOS and Android.

## C. DOWNLOAD THE CONNEXOON ACCESS APPLICATION to your smartphone



- [A] Enter the email address and password that you defined when activating your Connexoon unit ([see page 13, Activation screen](#)). 

- [B] Define your user name.  
Via the user name, you can find out what actions have been performed from your smartphone.

You can change your user name at any time in the "Settings" tab in the menu  that you will find in the history ([see page 34, Menu](#)).



## **[ 3 ] USING CONNEXOON ACCESS**

## A. THE INTERFACE

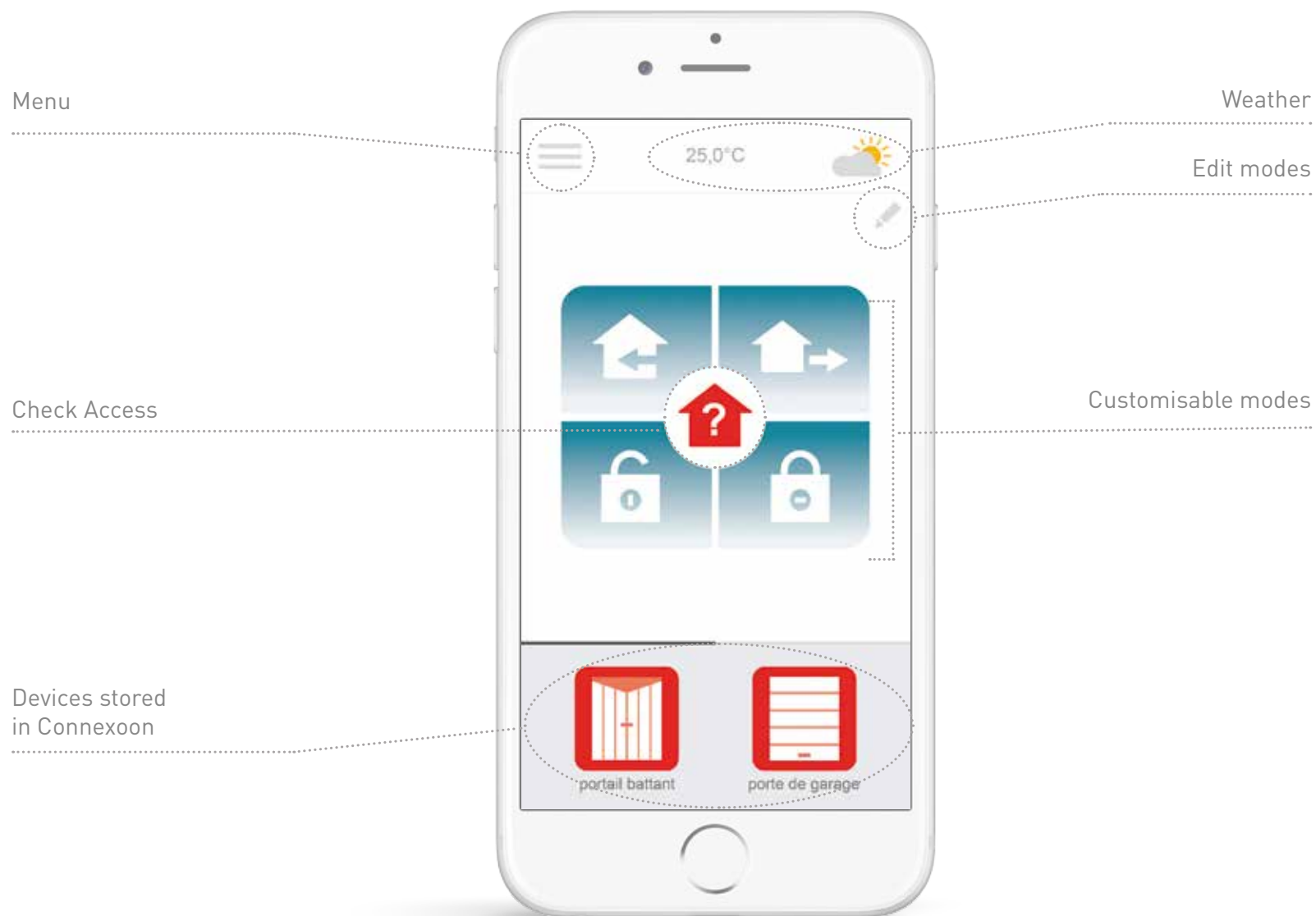

## B. CONTROLLING MY PRODUCTS

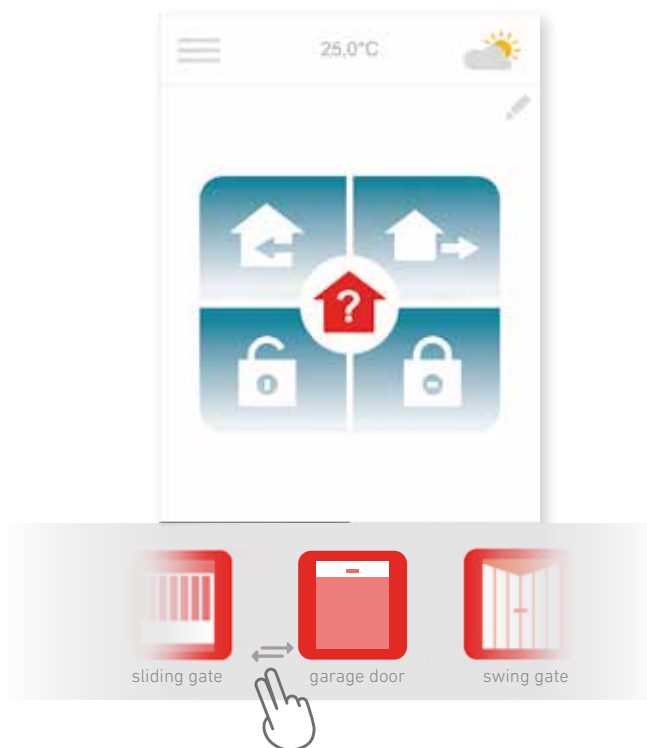

- [A]** You can control your gate, garage door, lighting etc. in the grey box at the bottom of the interface.

Press the icon corresponding to the device you want to control by dragging the list to the right or left (for example: garage door).

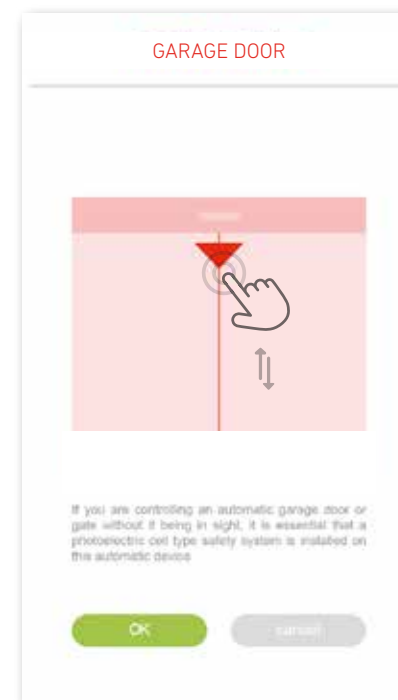

- [B]** Adjust its position using the arrow and then press **OK**.

## C. THE MODES



Connexoon Access has 4 modes “I’m arriving – I’m going out – Open all – Close all”.

You can customise each of these modes by choosing the actions you want to perform: open or close your gate, turn your lights on or off, open or close your garage door.

You can then find your modes again with a single press!

*For example: When I arrive home, my gate opens, my outside light comes on and my garage door opens at a single press.*

## C. THE MODES

### Open all / Close all

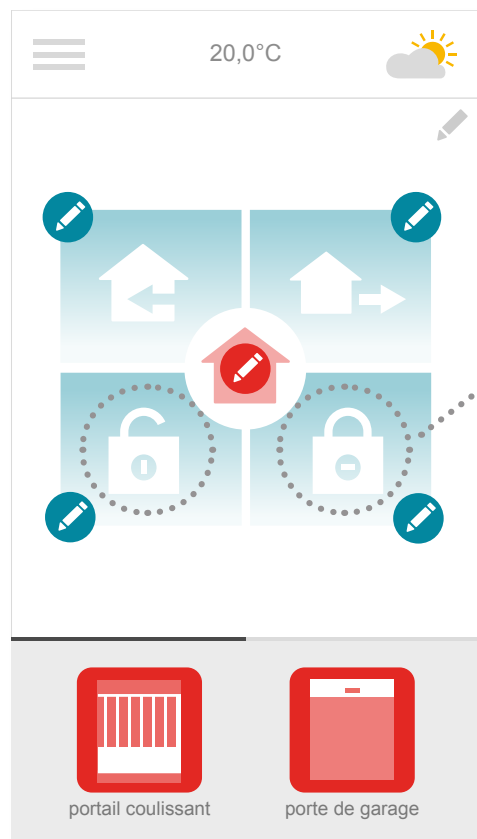

When you arrive or leave home, open or close your gate and/or garage door and turn the outside lights on or off – all with a single press.



## C. THE MODES

### Open all / Close all

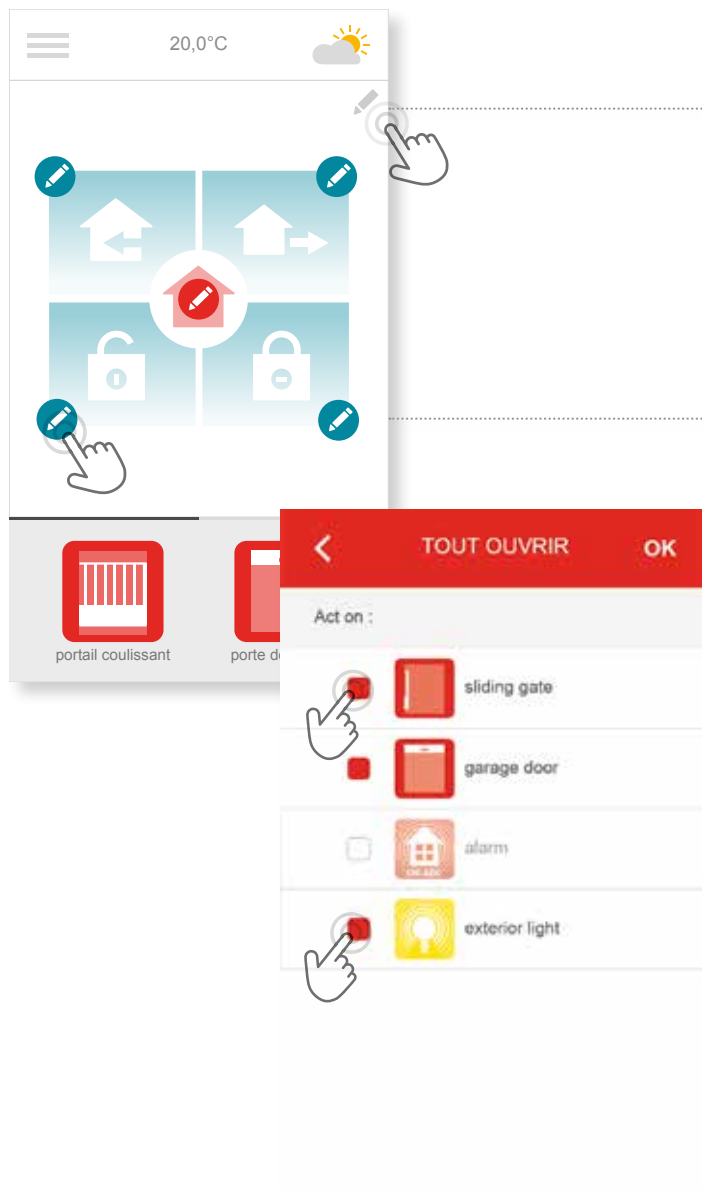

[A] Press  to customise your “Open all / Close all” mode.

Then press  on the  icon to customise the **Open all** mode or press  on the  icon to customise the **Close all** mode.

[B] Select the devices you want to activate and then press OK to confirm.

## C. THE MODES

### I'm going out



When you want to go out, press once to open your gate which will then close again automatically after the period of time you have specified.

## C. THE MODES

### I'm going out

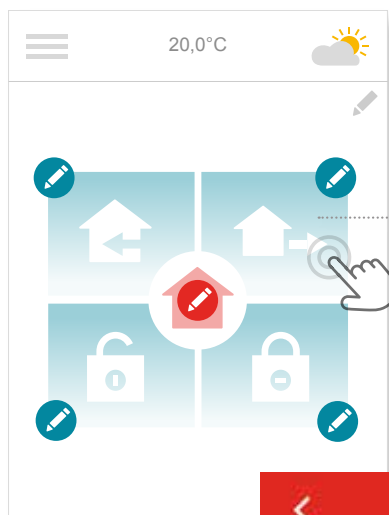

[A] Press  on the  icon to customise the "I'm going out" mode.

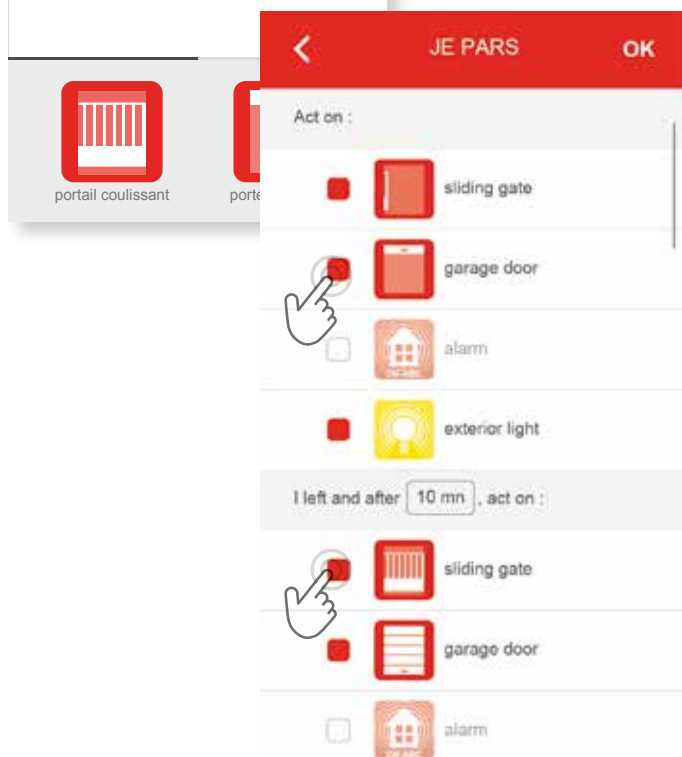

[B] Select the devices you want to activate when you go out.

[C] Define the period of time after which you want your devices to respond.

[D] Select the devices that you want to activate a few minutes after you have left.

## C. THE MODES

### I'm arriving

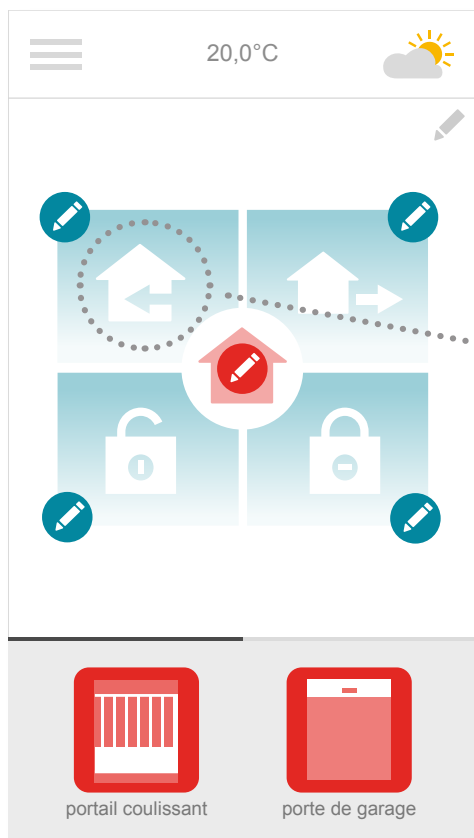



Thanks to the geolocation function, your home welcomes you when you get back. Define the distance between you and your home at which you want the devices you have defined to be activated.

*For example: When I leave the office in the evening, I activate the "I'm arriving" mode. The geolocation function is then activated and my home welcomes me in the way I specified.*

## C. THE MODES

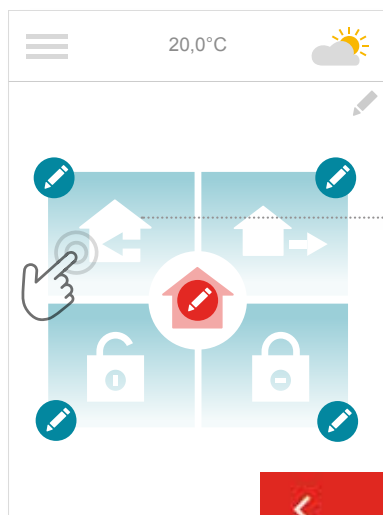
### I'm arriving



[A] Press  on the  icon to customise the "I'm arriving" mode.

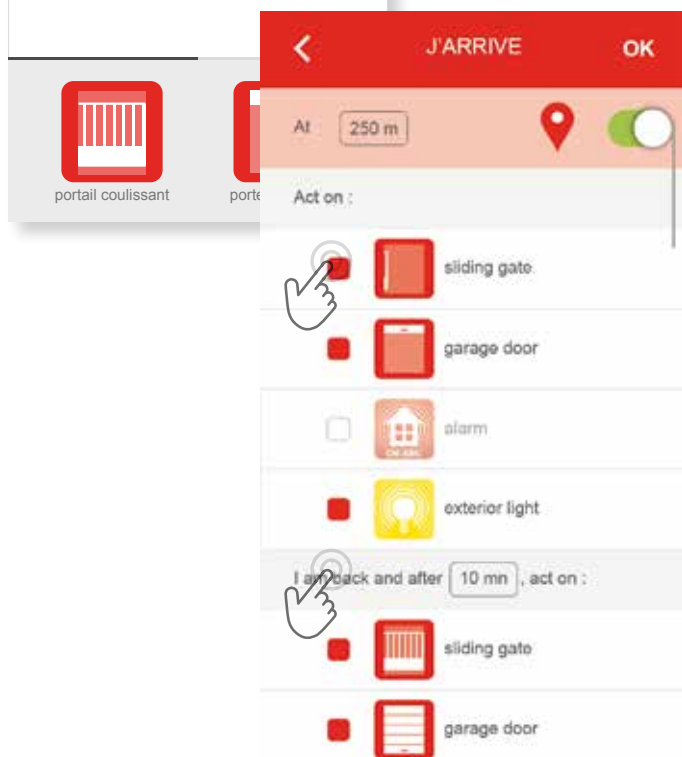

[B] Define the distance at which you want to activate your "I'm arriving" mode and activate or deactivate geolocation.

[C] Select the devices you want to activate before your arrival.

[D] Define your return journey time: the mode is activated on your arrival.

[E] Select the devices you want to activate after your arrival.

## D - CHECK ACCESS



Wherever you are, simply press the “Check Access” icon to reassure yourself that your gate and garage are closed and your lights are off.

## D - CHECK ACCESS

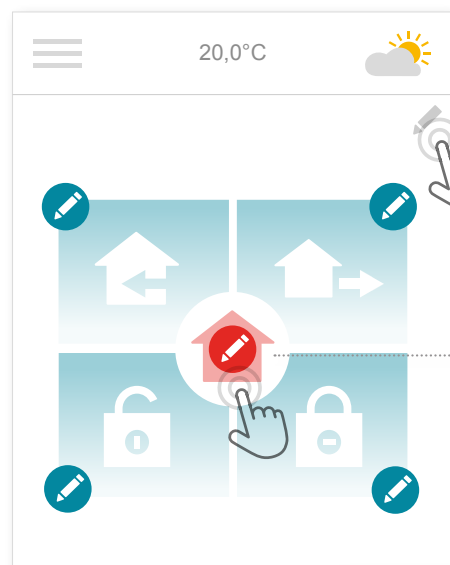

[A] Press the button .

[B] Press  in the centre of the interface.

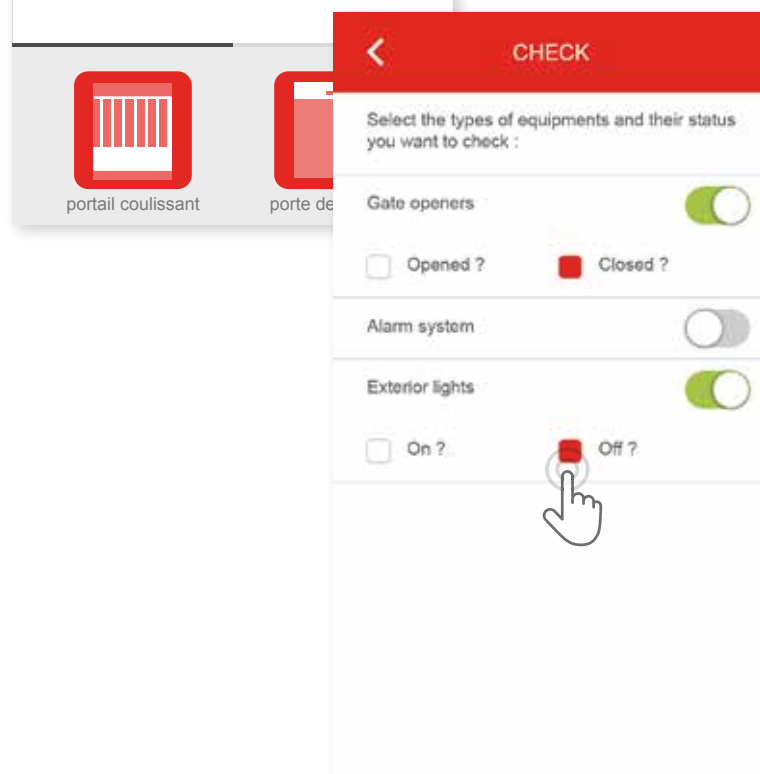

[C] Select the devices and statuses you want to check and press Check Access.

*For example, after leaving home, I can check that my garage door is properly closed and that my outside lights are off.*



## **[4] MANAGING MY INSTALLATION**

# MANAGING MY INSTALLATION

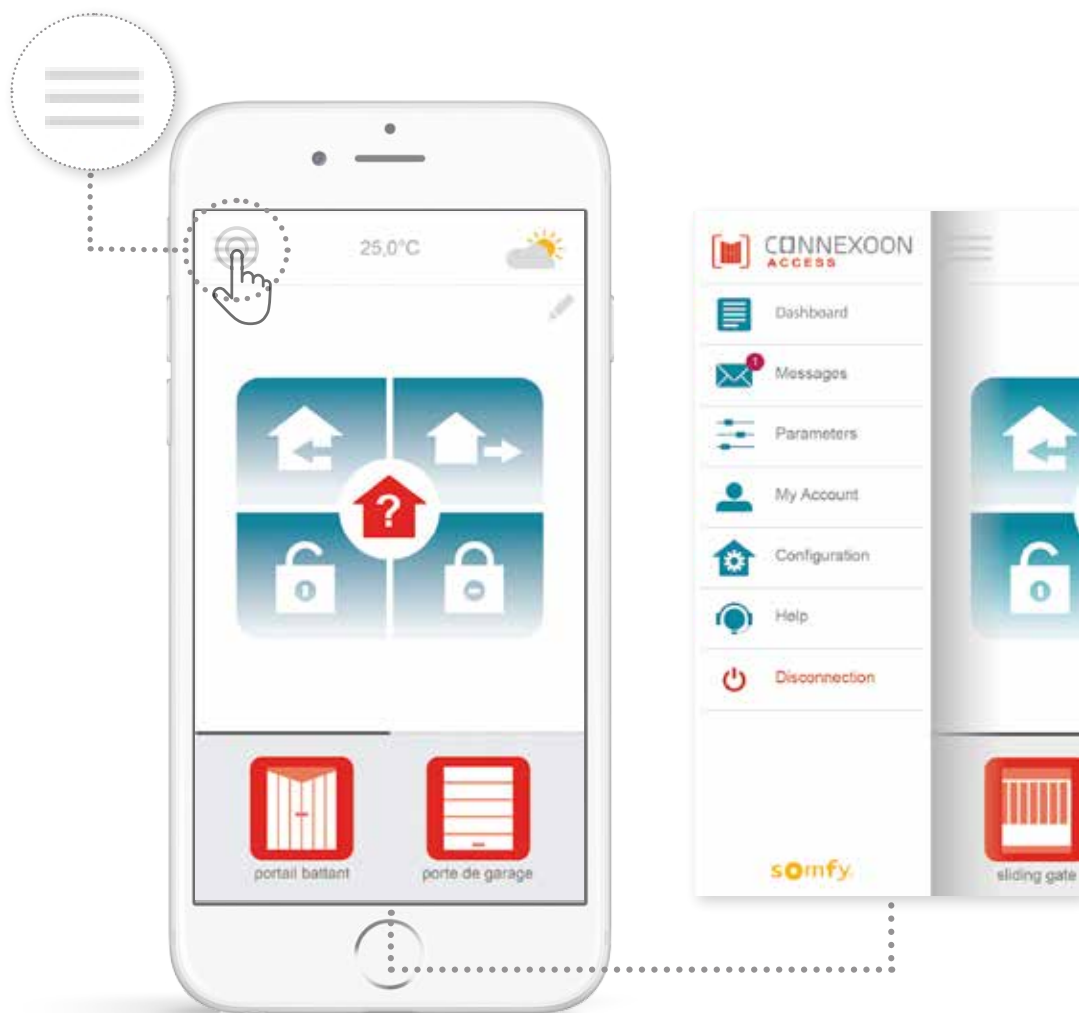

You can press  to access a number of functions that you use to make settings and manage your Connexoon Access application:

- the dashboard,
- your messaging service,
- the settings,
- your account,
- the help system,
- disconnection from the application.

The “Configuration” menu is used to access the advanced installation functions. ([see section 5](#)).



# A. DASHBOARD

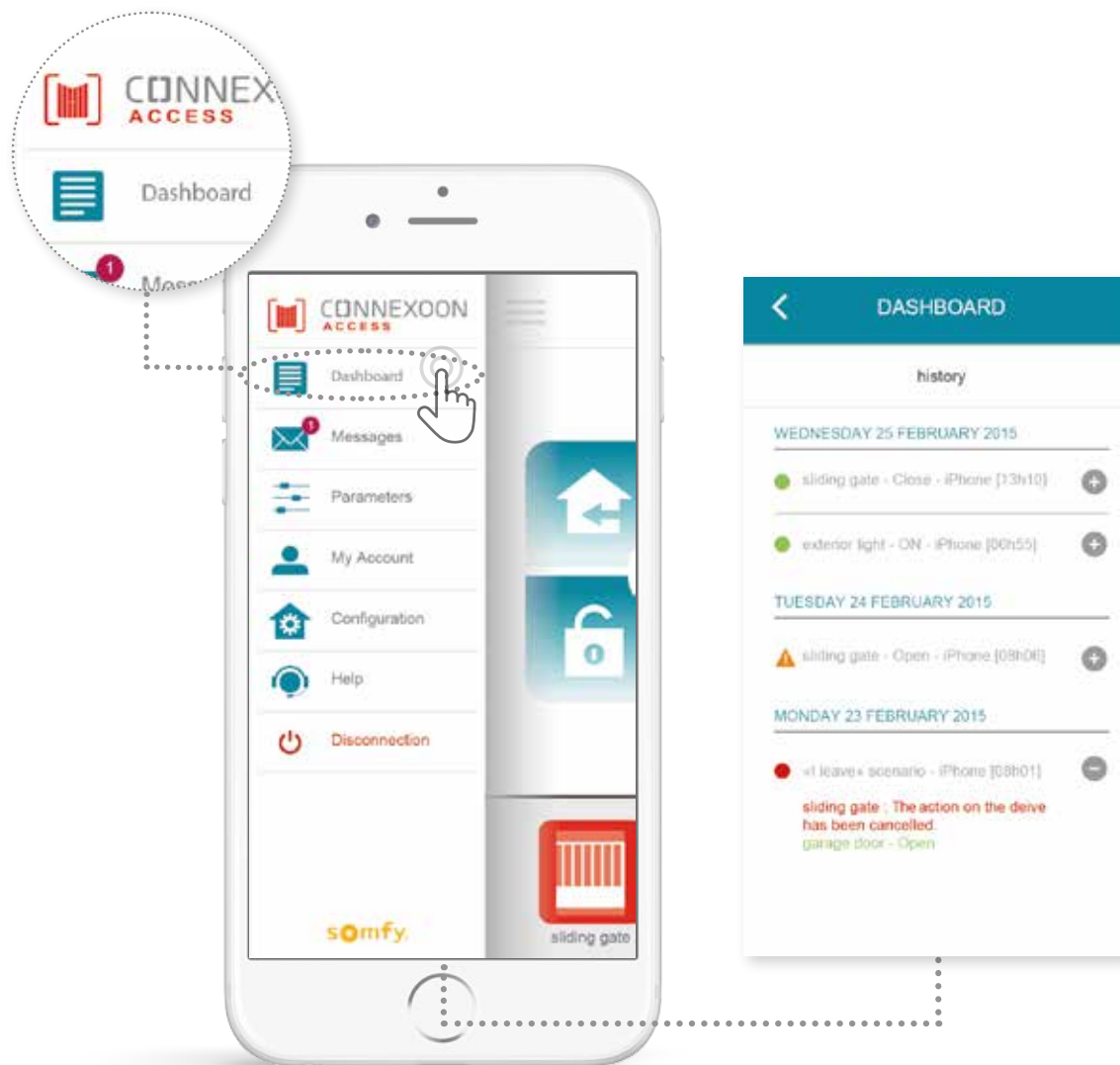

Just press on this menu to open a history of all your connected devices.

- A **green dot** in front of a command indicates that the action was completed correctly.
- A **red dot** indicates that the action was interrupted deliberately.
- An **orange triangle** indicates that a problem occurred.

Press the  icon for more information.

## B. MESSAGES

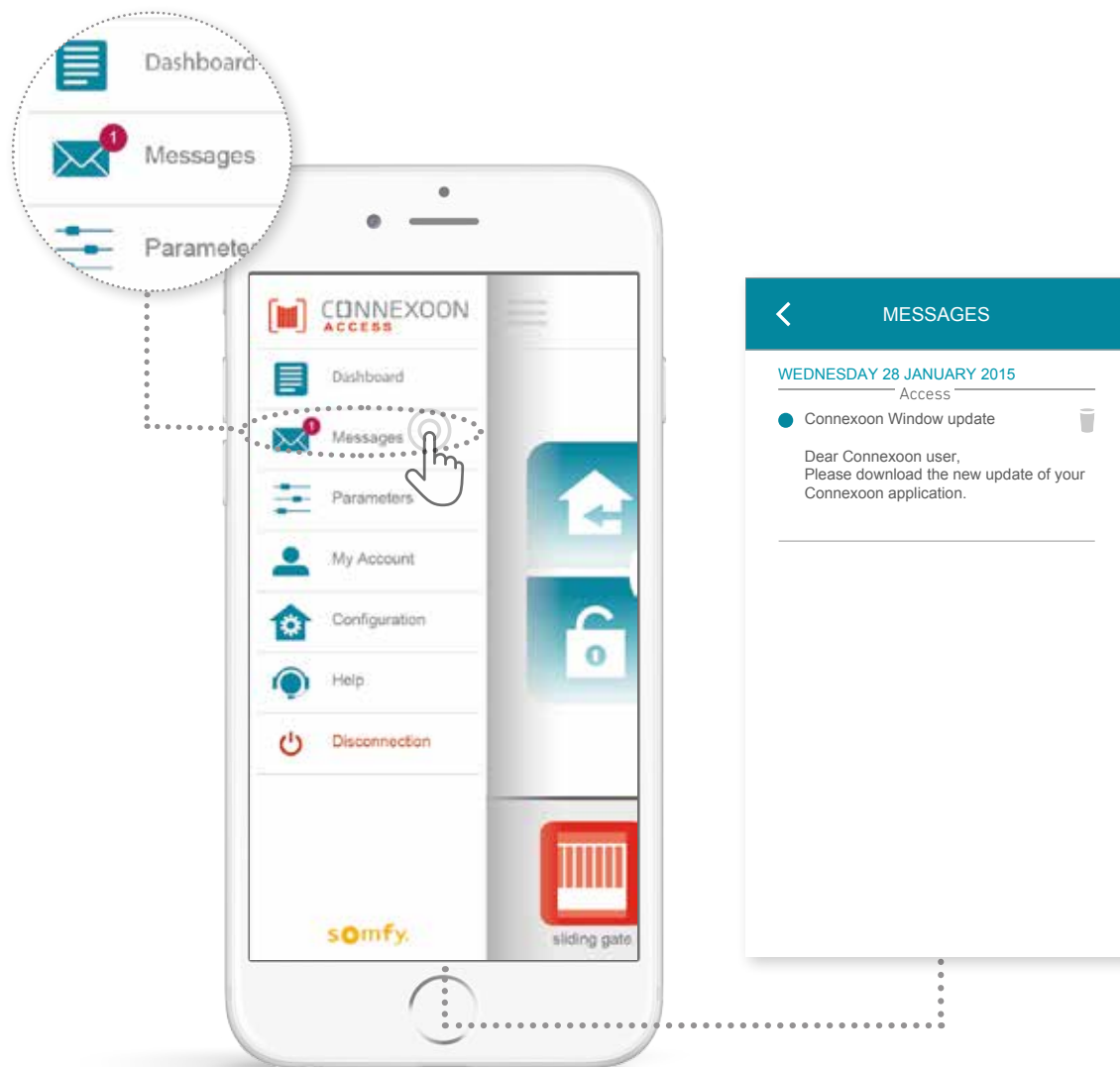

You will find all the information you need about updates and planned new features in your Connexoon messaging system ("Messages" menu).

## C. SETTINGS

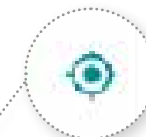
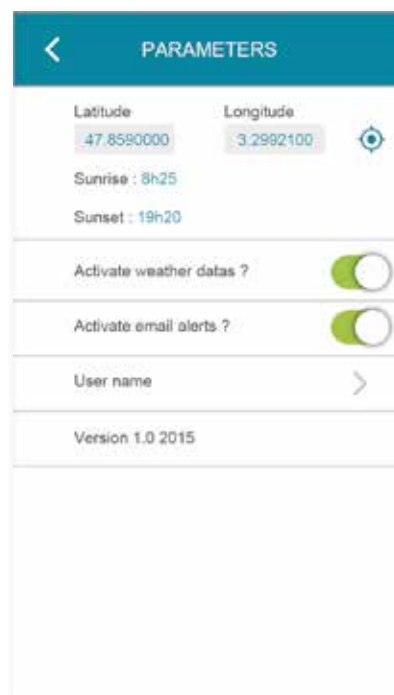
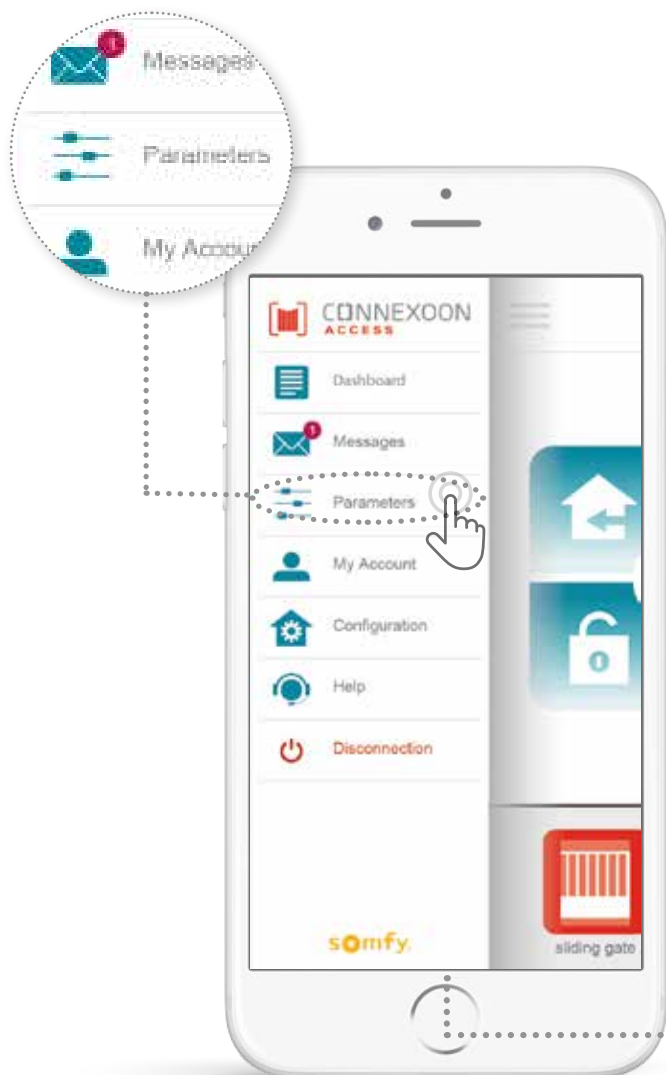

Specify the geolocation of your home in order to receive local weather information.



Activate / deactivate the weather display on the home page.



Activate / deactivate email alerts.



Change your user name.

This menu allows you to activate the display of weather data and activate alerts and/or push notifications. It also allows you to display the widgets on your smartphone and/or Apple watch and to define your user name so that you can customise **your history**.

## D. MY ACCOUNT

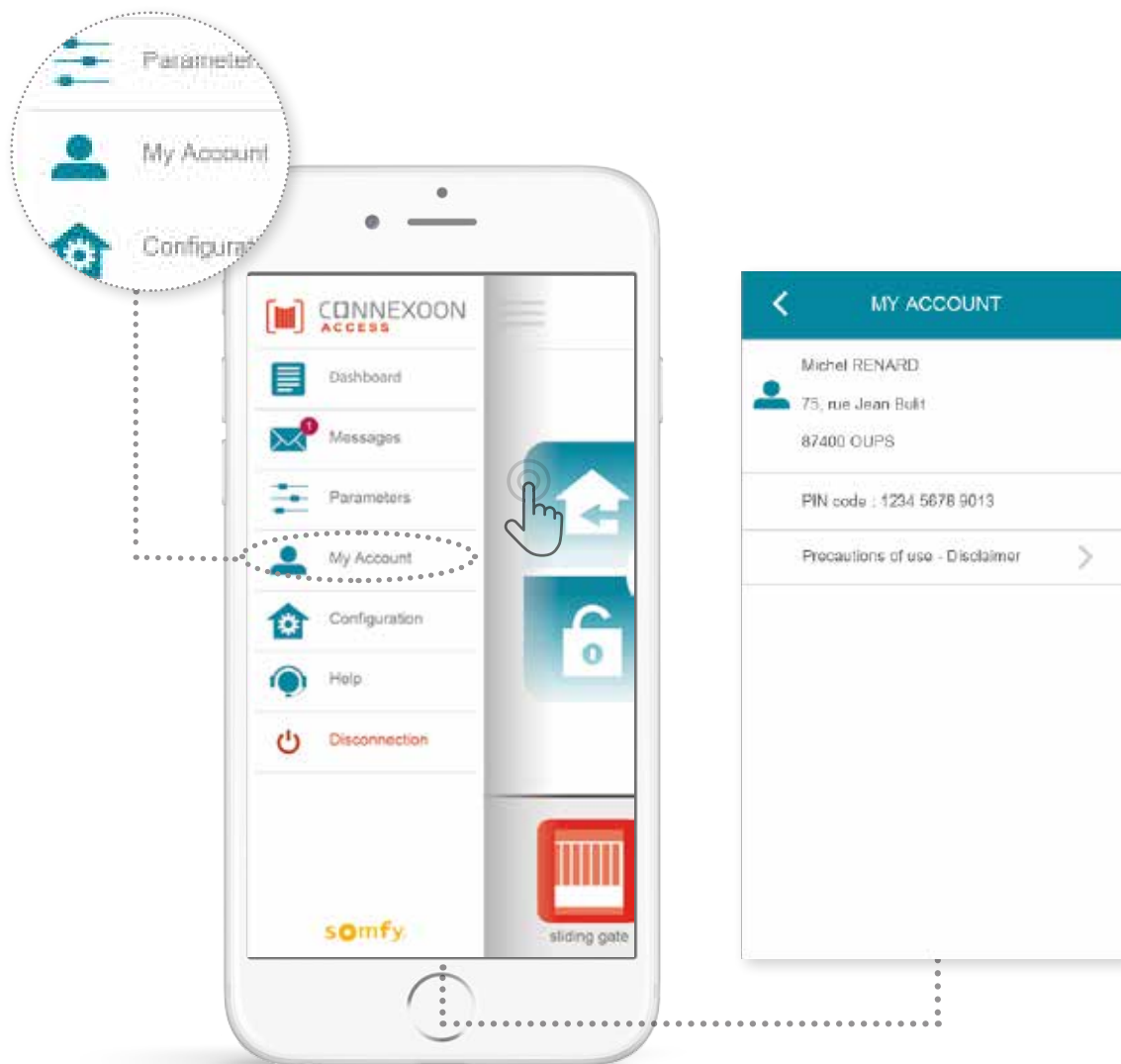

This tab contains the information you entered when you activated Connexoon.

## E. HELP

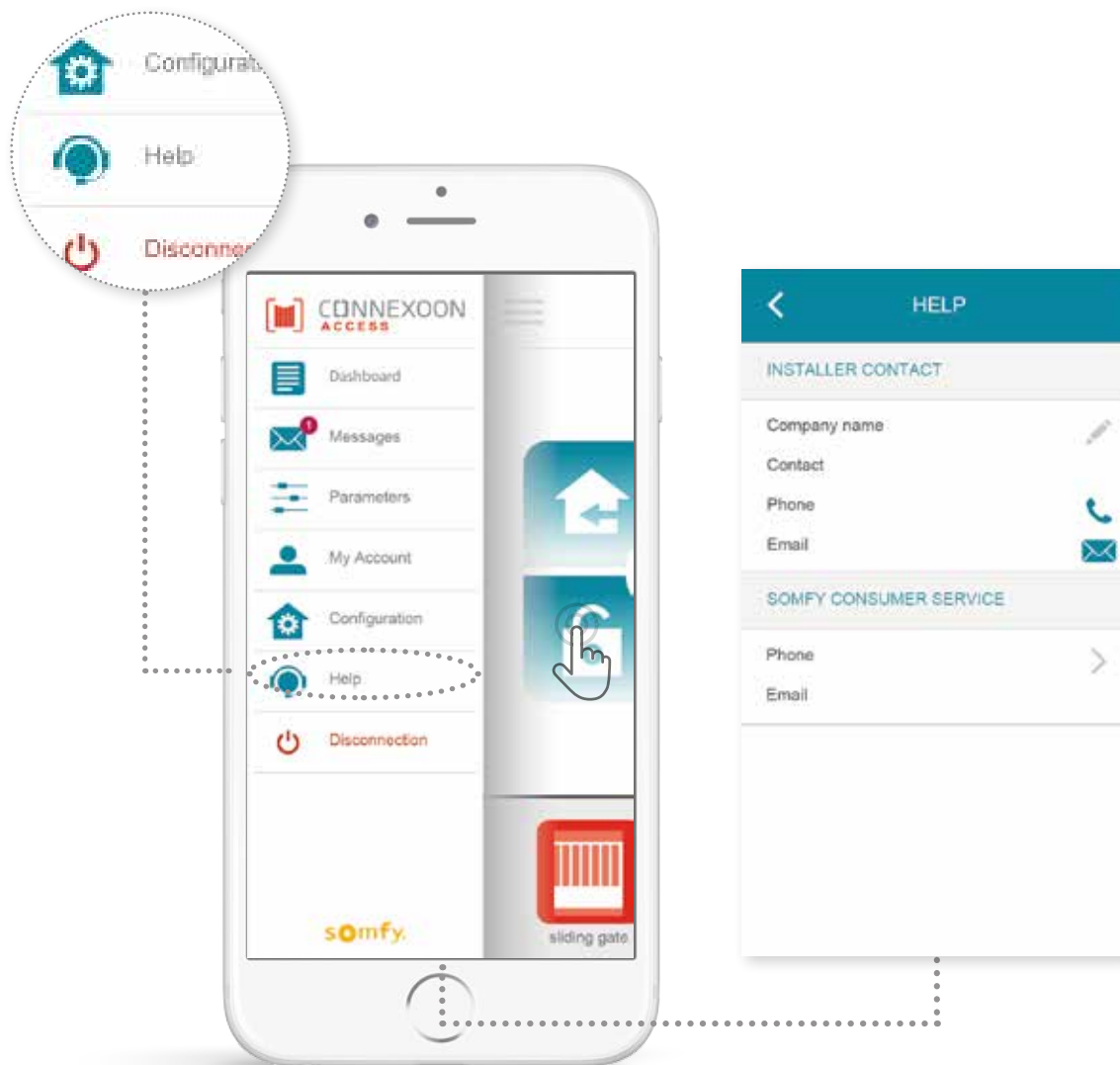

Either you or your installer may fill in the information in this tab so that you can contact him directly if you have any questions.

Stay in touch with the installer by entering his contact details in the application. Just press once to contact him.

You can also press to call up the number of the Somfy Consumer Service.



## **[5] ADVANCED INSTALLATION FUNCTIONS**

# ADVANCED INSTALLATION FUNCTIONS



In this menu, you can:

- Store new io-homecontrol devices that are compatible with your Connexoon
- Remove / rename devices
- Manage the installation's io-homecontrol security key  
(Caution: These functions can impair the correct functioning of your Connexoon and should only be used by **your installer**)

To access these functions, press .

# A. CONNECTING IO-HOMECONTROL DEVICES

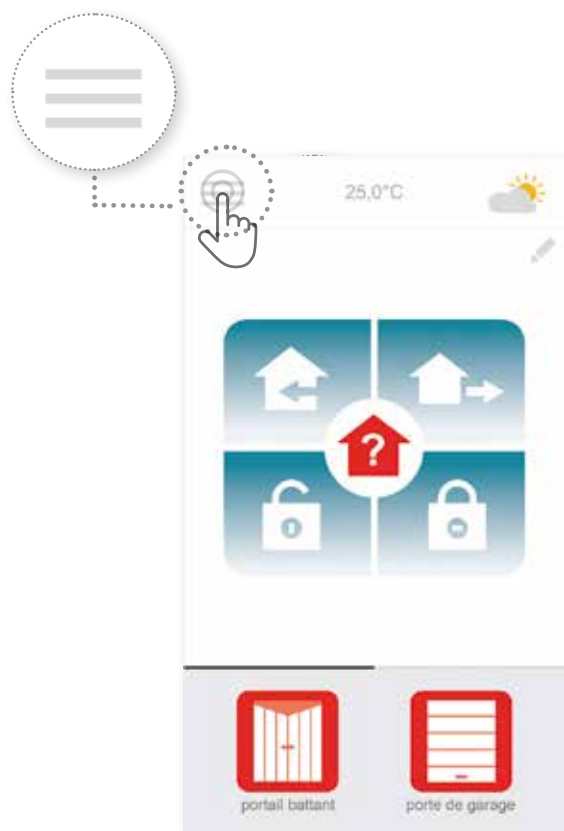

[A] Press the menu.

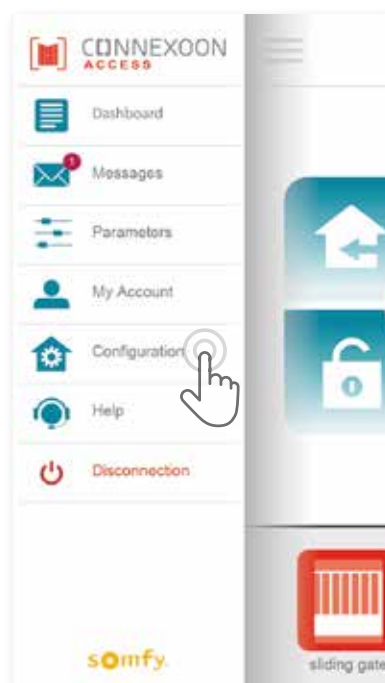

[B] Press the Configuration tab .



[C] Press .

# A. CONNECTING IO-HOMECONTROL DEVICES



- [D] Select the type of product that you want to add to the installation: io drives/actuators, io sensors or detectors or Philips Hue lighting, then press **OK** to confirm.



- [E] Select the type of control point – 1-way or 2-way – that controls the devices you want to connect and then follow the procedure indicated on the screen to connect the io devices.

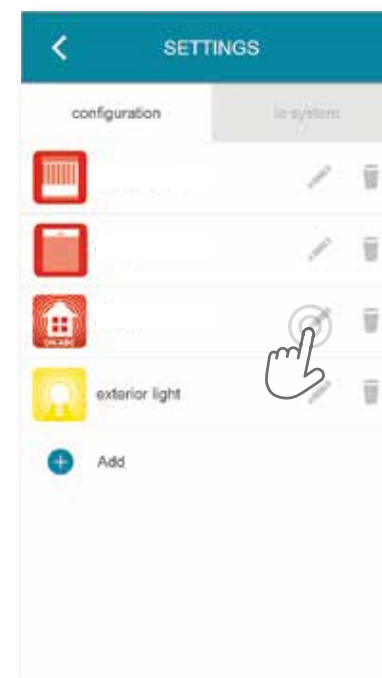

- [F] The devices are stored. You can:
- Rename them by pressing
  - Remove them by pressing

## B. MANAGING THE IO-HOMECONTROL SECURITY KEY

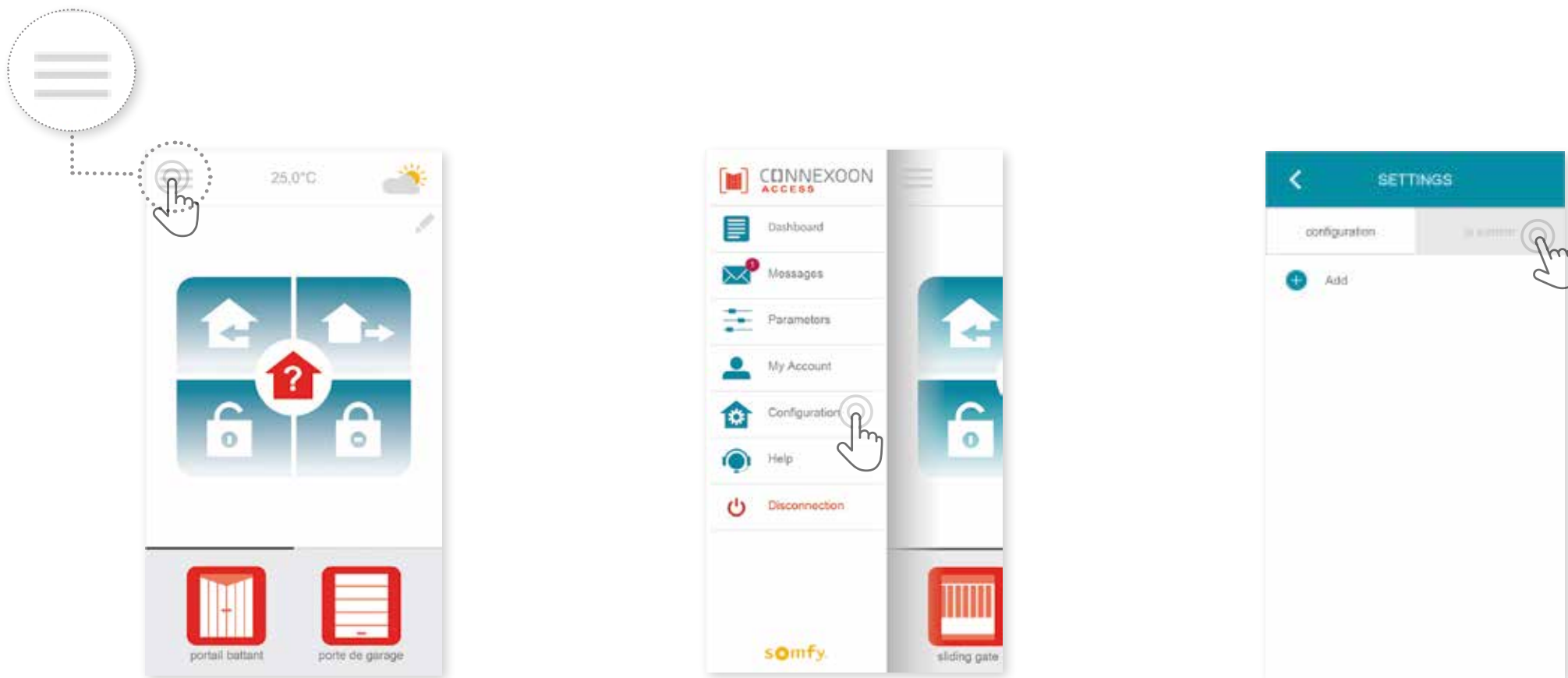

[A] Press the  menu.

[B] Press .

[C] Press the “io system” tab.

It is important that the Connexoon unit, all your devices and their control points have the same security key.  
The “io System” menu can be used to manage this key.

## C. SENDING THE IO-HOMECONTROL security key of the Connexoon unit to an io-homecontrol remote control with feedback function (2-WAY)

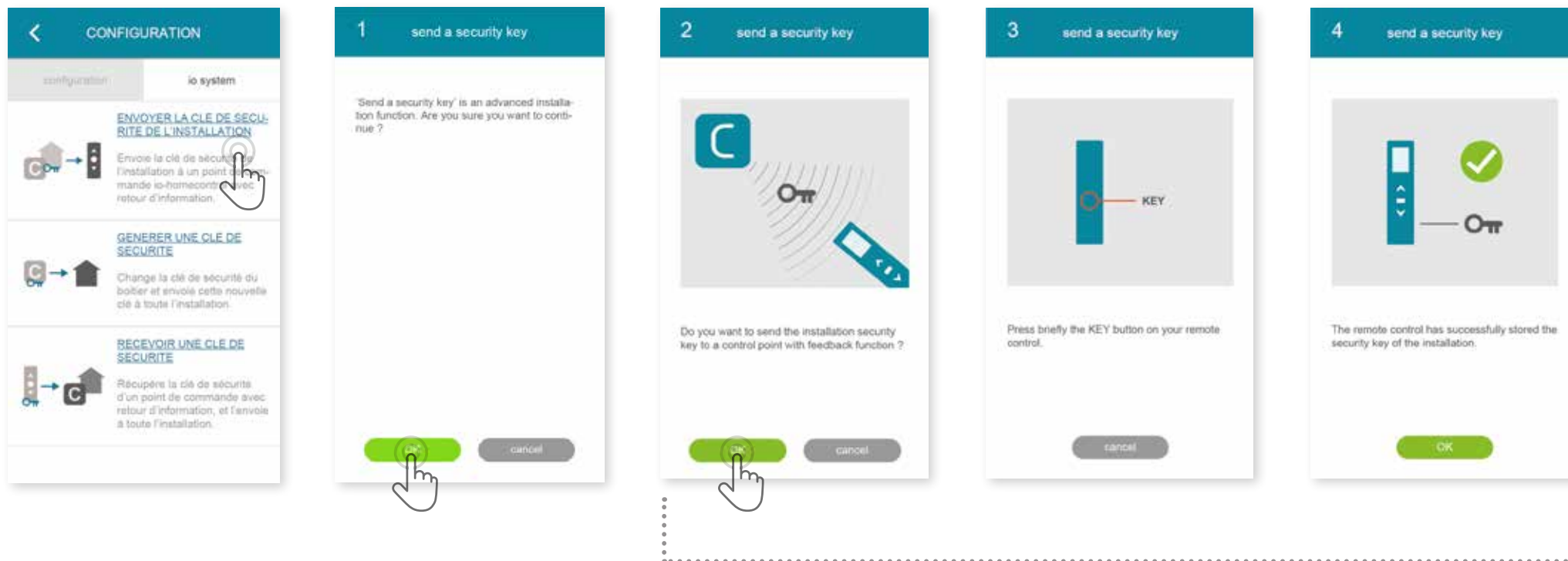

[A] Press the  icon.

[B] Press  to confirm your choice.

[C] Follow the instructions.

## D. GENERATING THE SECURITY KEY

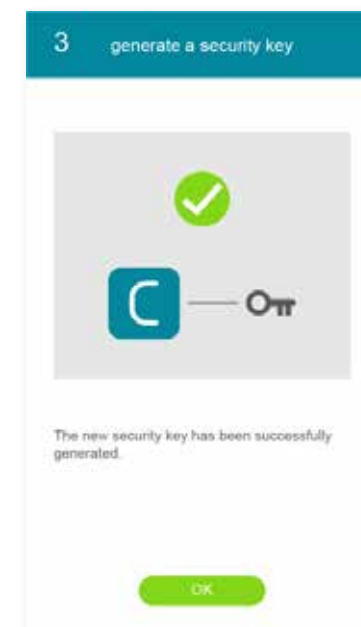
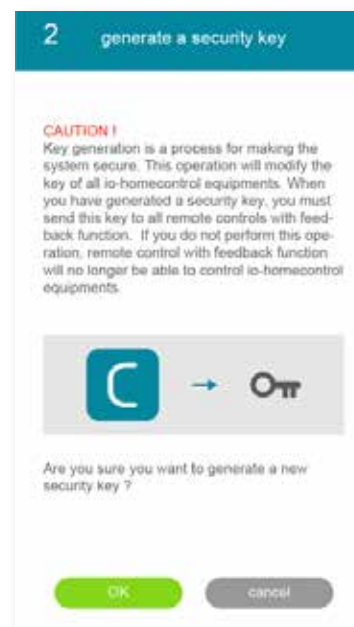

[A] Press the icon .

[B] Press  to confirm your choice.

[C] Read the precautions relating to generation carefully and then follow the instructions.

Used to load the security key of the Connexoon unit and the devices.

# E. RECEIVING AN IO-HOMECONTROL SECURITY KEY

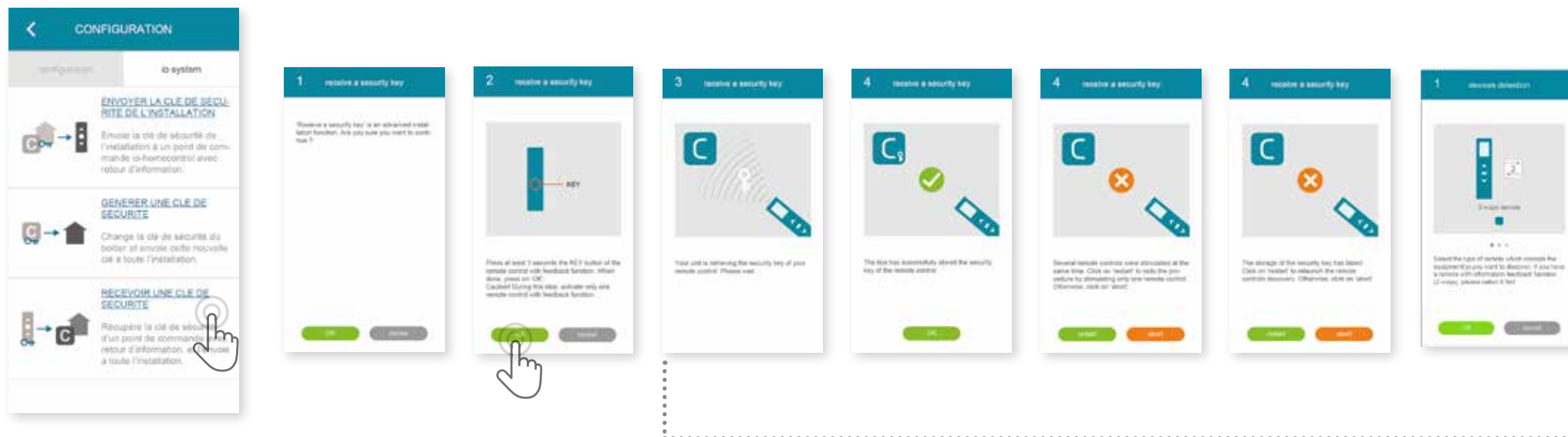

[A] Press the  icon.

[B] Press  to confirm your choice.

[C] Read the precautions relating to generation carefully and then follow the instructions.

This is used to retrieve the security key from a control point with feedback function (2-way) and then assign it to all the devices and the Connexoon unit.



# AVAILABLE TUTORIALS

List of available video tutorials

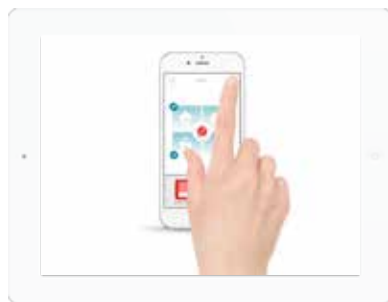

 TUTORIAL # 1  
Welcome Access

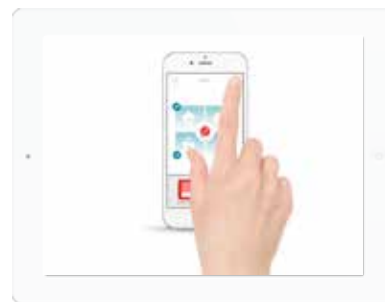

 TUTORIAL # 2  
Check Access